

Chauvin Flapless TED Quick Check

(All instructions below are for offshore configuration. Your TED should meet the minimum stretch for your fishing area.)

DEVICE:

- **Flapless Configuration:** Flaps must be fully removed for flapless credit.
- **TED Grid:** At a minimum, must follow TED grid regulations for the double cover opening.
 - Angle of grid between 30 and 55 degrees
 - Bar spacing is 4 inches maximum
 - Grid length and width must be ≥ 32 inches
 - Must be top-shooting (required for Chauvin)
- **Opening:** At a minimum, must follow TED regulations for double cover opening.
 - Leading edge must be ≥ 56 inches
 - Forward cut must be ≥ 20 inches
- **Chauvin Shrimp Deflector:**
 - 30-inch long uncapped PVC pipe (3-inch inside diameter)
 - PVC must be “loose” in $1 \frac{3}{8}$ inch stretched-mesh webbing bag that is 57 meshes by 10 meshes.

CONSTRUCTION AND PLACEMENT:

- Wrap one 57-mesh end around the PVC and attach at 3 meshes below the opposite end. Sew the sides to close the mesh bag and keep the pipe free.
- Sew the 3-mesh tail inside the net at 3 meshes forward of the TED opening in a single row.
- There should be 3 meshes of opening on either side of the PVC bag. (see figure)
- The bagged PVC should **NOT** be outside of the TED opening AT ANY TIME.

COMMON MISTAKES:

- PVC issues: *NOTE: there is no specified schedule for the PVC:*
 - Wrong size: Must be 3-inch interior diameter PVC
 - Wrong length: Must be 30 inches in length
 - Capped: PVC must remain open-ended
 - Sewn-in: PVC must be “loose” within the bag
- TED does not meet minimum stretch:
 - Make sure the PVC bag is attached 3 meshes forward of opening and only along the bag tail.

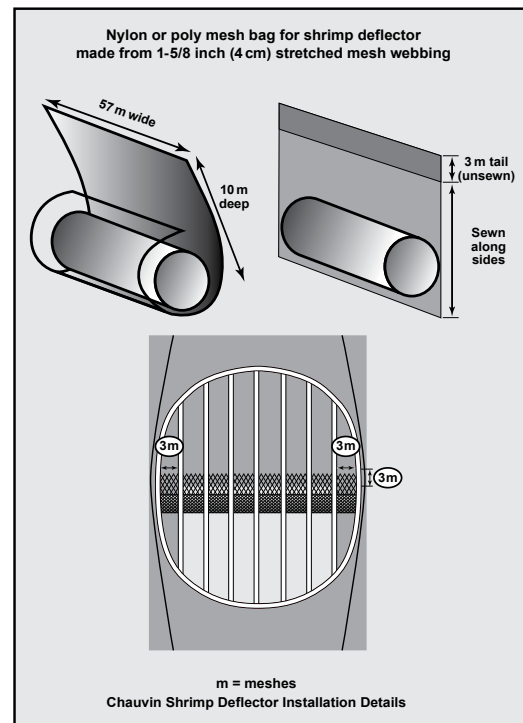

Chauvin Flapless TED Quick Check

